

MAPX	MODIFICATION	DATE

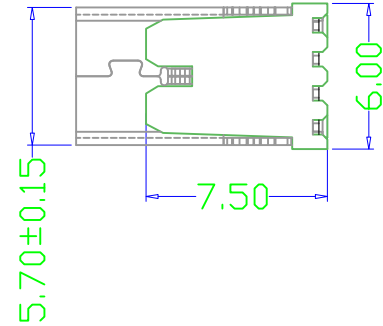

NOTE:
 1. Material:
 Housing: Thermoplastics
 Contact: Phosphor Bronze C5191-EH/C2680-EH, T=0.25mm
 Shell: COPPER ALLOY T=0.30mm
 2. FINISH:
 Contact: 15u" Gold Plated on Contact Area,
 80u" Min.Tin Plated on Solder Area
 50u" Min.Nickel Underplating Over All.
 Shell: 50u" Min.Nickel Underplating Over All.
 3. Specification:
 3.1: Rating:
 Rated voltage 500V AC/DC. Rated current: 2 A Max.
 3.2: Electrical:
 Insulation Resistance(EIA-364-21):
 1000M Ω Min. at 500V/DC for 1Minute.
 Contact Resistance(EIA-364-23):
 30 m Ω Max. at 20mV Max, 50mA
 Dielectric Withstanding Voltage(EIA-364-20):
 No discharge, flashover or breakdown at 500V/AC
 1Minute
 4. Plug extraction force shall be between 1.0kgf and 2.00kgf
 5. Contact finish:
 01: Selective Gold Flash
 02: Selective Gold 3U"
 03: Selective Gold 5U"
 04: Selective Gold 15U"
 05: Selective Gold 30U"

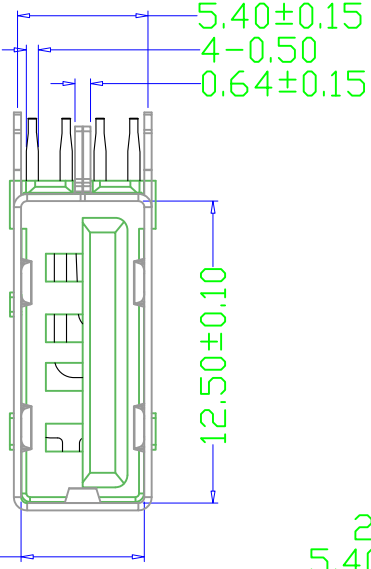
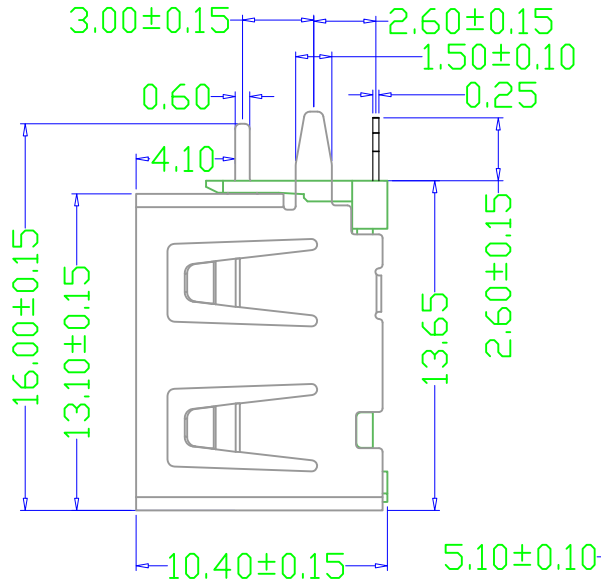
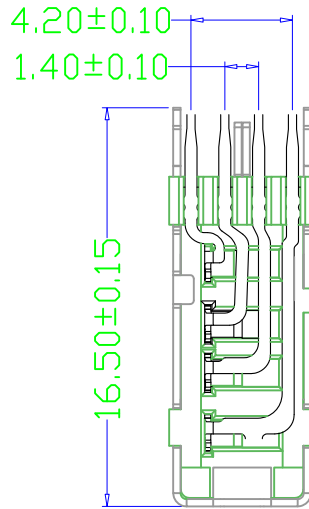
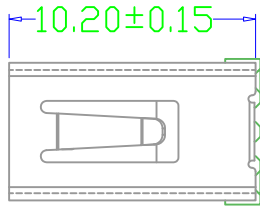
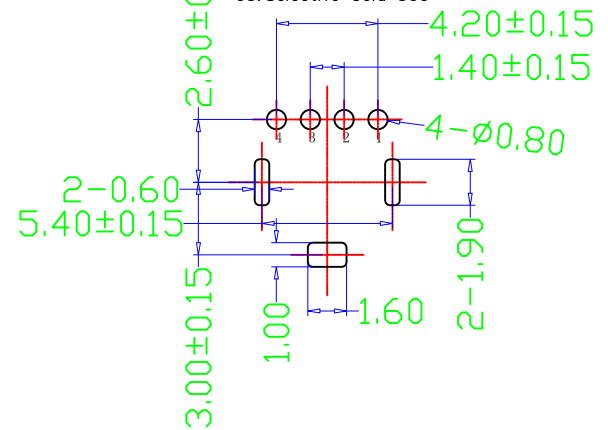

RECOMMENDED PCB LAYOUT
 GENERAL TOLERANCES: ± 0.05

<p>产品图 PRODUCT CHART DWG</p>										
<p>公差一览表 TOLERANCE UNLESS OTHERWISE</p>				单位 UNITS	MM	制图 DRAWING	Z-Y-B	制图料号 PRODUCT PART NO.		
X.	± 0.25	X.	$\pm 5.^\circ$	比例 SCALE	1:1	审核 CHKD		产品名称 PRODUCT NO.	C39451	
.X	± 0.20	.X	$\pm 2.^\circ$	日期 DATE	2014. 02. 20	核准 APPD		角法 VIEW	版本 VER	AO
.XX	± 0.15	.XX	$\pm 1.^\circ$							
.XXX	± 0.10	.XXX	$\pm 0.5^\circ$							